

# 润金科技



## User Manual

宁波市

润金机电科技有限公司

KH

宁波市 润金机电科技  
有限公司

1                    宁波市 润金机电科技有限公司

2







3

4                    KH1512 KH1509 KH1209 KH0906 ,

5

24

**400 680 9891**

<b>1</b>	-----	<b>4</b>
1-1	-----	4
	-----	4
1-3	-----	4
1-4	-----	5
1-5	-----	6
1-5-1	-----	7
1-5-2	-----	7
1-5-3	-----	7
1-6	-----	8
1-7	-----	8
1-7-1	-----	8
1-7-2	-----	8
<b>2</b>	-----	<b>10</b>
2-1	-----	10
2-2	-----	10
2-3	-----	11
2-3-1	-----	11
2-3-2	-----	12
2-4	-----	13
2-4-1	 -----	13
2-4-2	 -----	14
2-4-3	 -----	14
2-4-4	 -----	15
2-4-5	 -----	15
2-4-5-1	 -----	15
2-4-5-2	 -----	16
<b>3</b>	-----	<b>17-</b>
<b>4</b>	-----	<b>18</b>

1

- 1-1-1
- 1-1-2
- 1-1-3
- 1-1-4
- 1-1-5
- 1-1-6

1-2-1

1-2-2                    5    40

1-2-3                    1    75

1-2-4

AC

8A

1-2-5

:

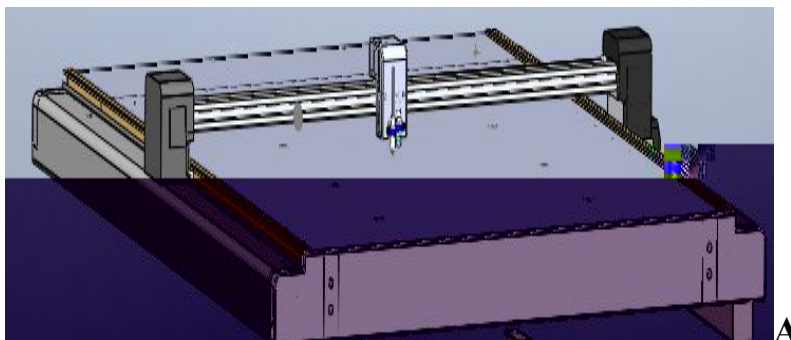

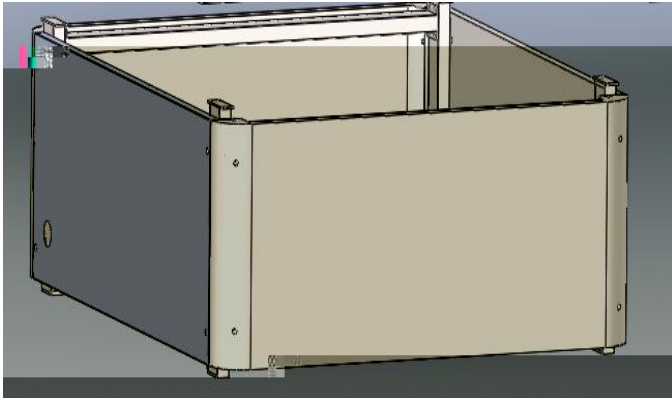

B

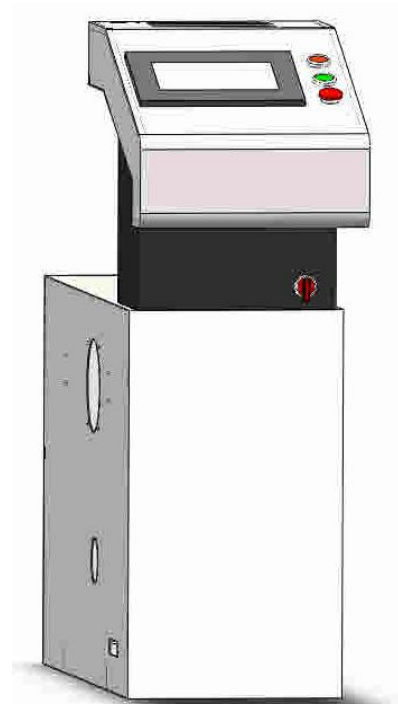

C

1-1

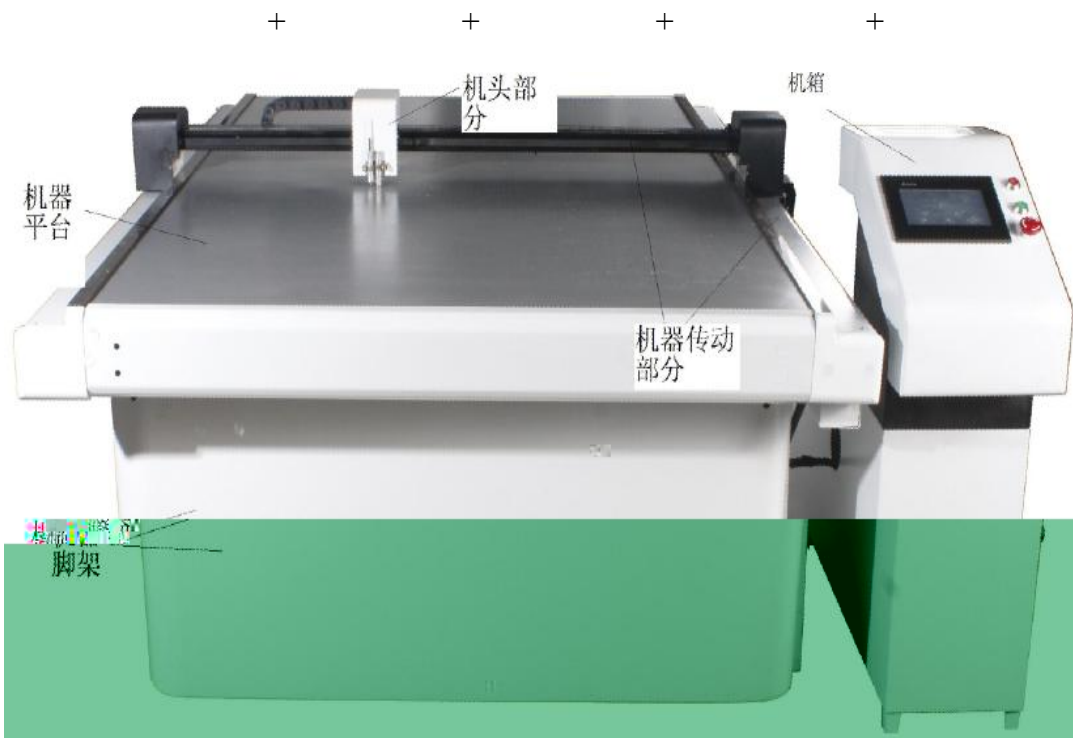

1-2

1-5-1

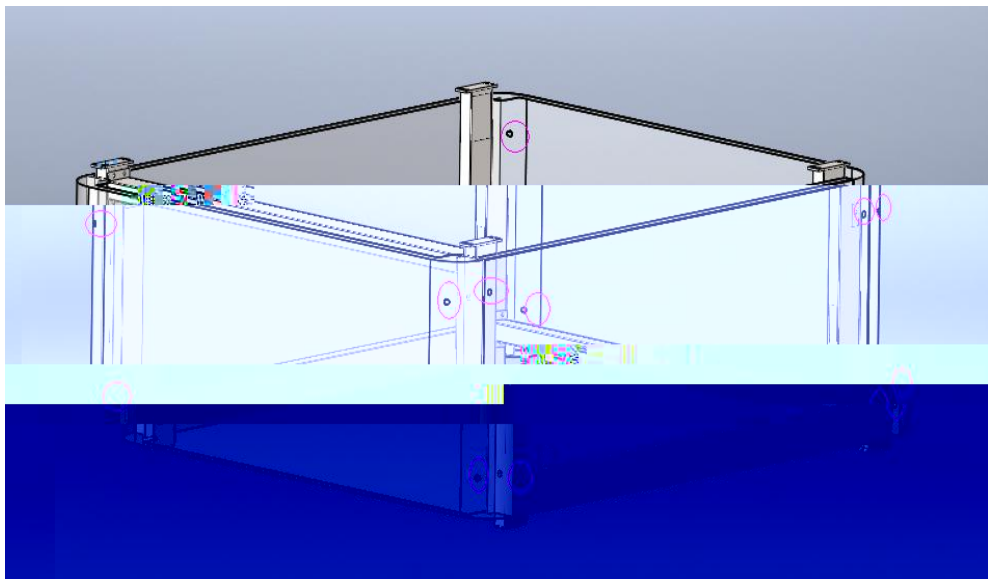

1-3

1-5-2

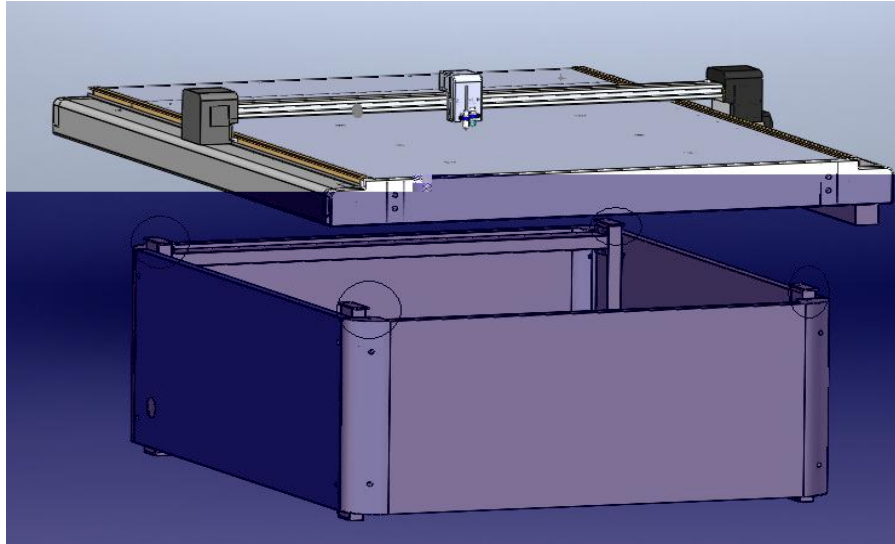

1-4

1-5-3

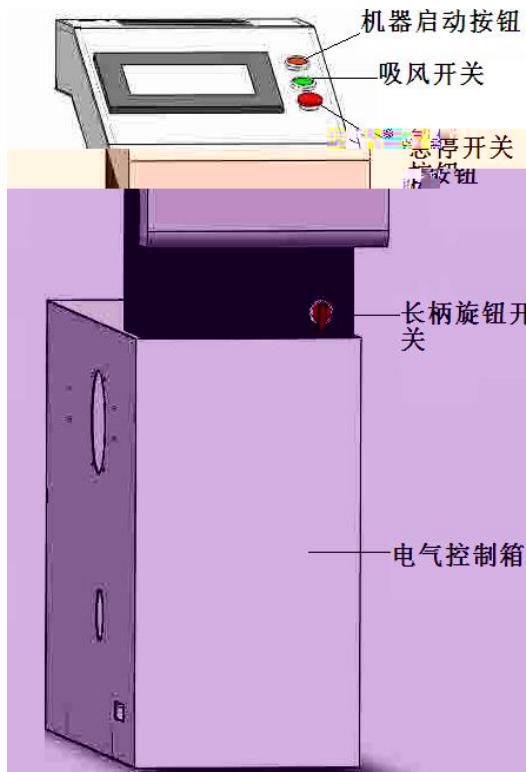

1 5

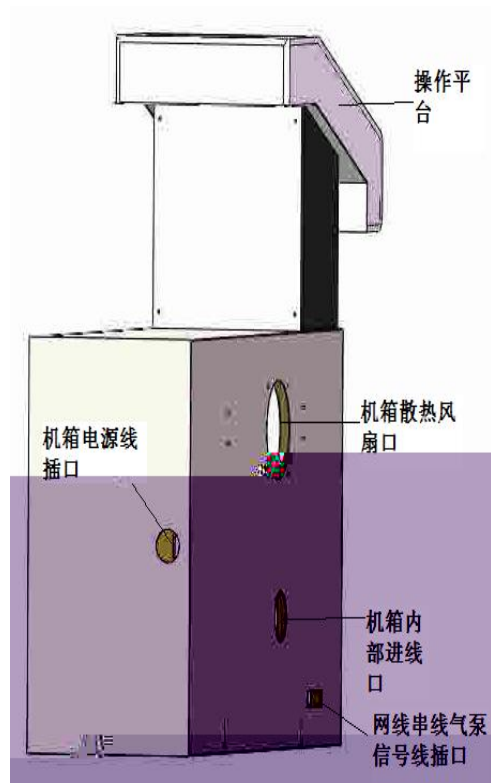

1 5

- 1
- 2
- 3
- 4
- 5
- 6

10

1-7-1

2mm

1 6

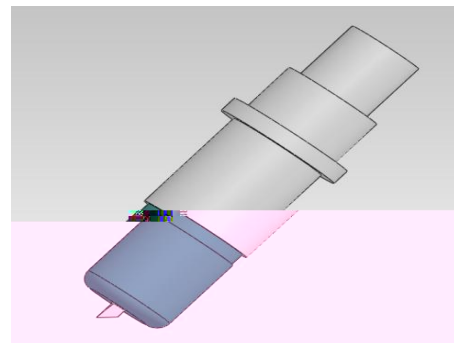
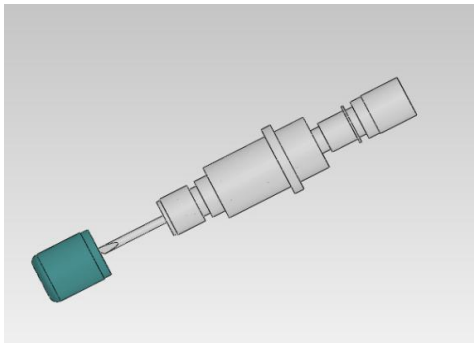

1-6

1-7-2

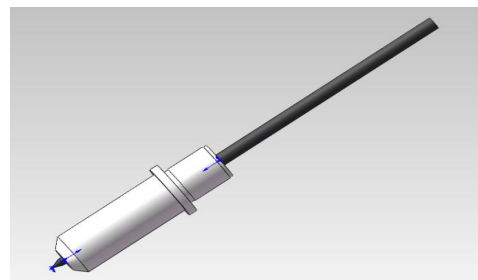
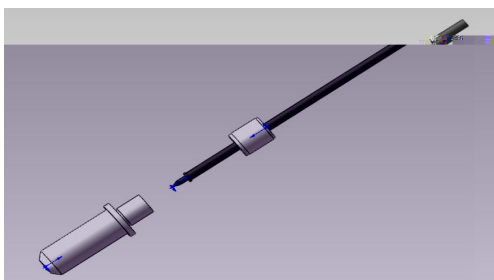

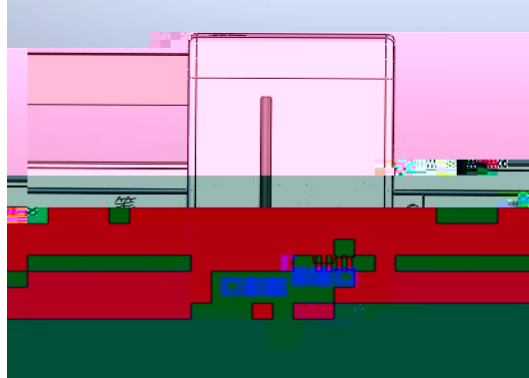

2-1-1

ON

3

3



Y

2-1-2

2-2



2-2-1 

X Y  
2-2-2 

2-2-3 

2-2-4 

2-4-5

2-2-5 

2-3

SP1

SP2

2-3-1



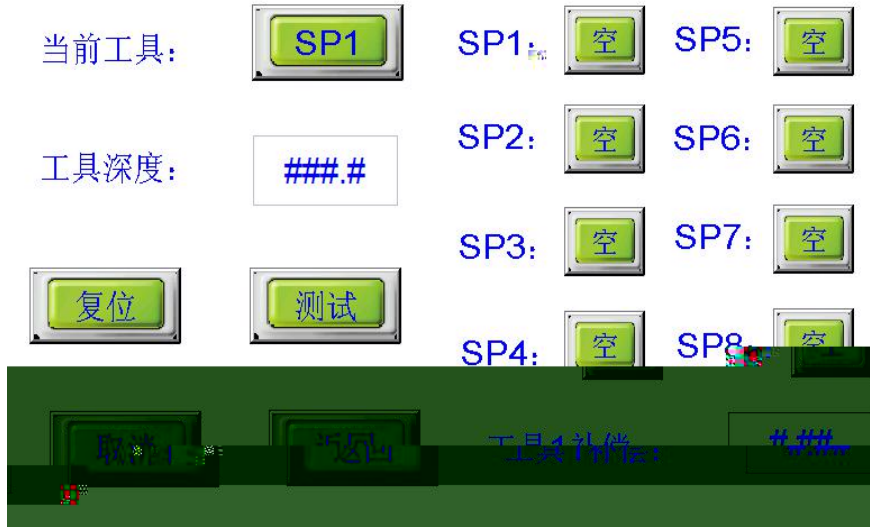

SP1-SP8

1 8

SP1 SP8

	SP
	SP
	SP

SP1

SP2



SP1

SP2



2-3-2

1





当前工具:  SP1:  SP5: 

工具深度:  SP2:  SP6: 

  SP3:  SP7: 

  SP4:  SP8: 

工具1补偿:

SP2  SP2

3.0 

20\*20mm

CAD

2-3-1

## 2-4

2-4-1 



测试速度: 

####  微调 

刀动作 

吸风 

工具测试 

临时原点 



工具测试

当前工具:

SP1

SP1:

空

SP5:

空

工具深度:

3

SP2:

空

SP6:

空

复位

测试

SP3:

空

SP7:

空

SP4:

空

SP8:

空

取消

返回

工具1补偿:

0.5

1

试刀

25CM

取消

返回

复位

笔动作

刀动作

气泡

临时原点

返回



笔速:	<input type="text" value="#####"/>	下笔延迟:	<input type="text" value="###"/>	z轴偏移:	<input type="text" value="###.##"/>
笔加速:	<input type="text" value="#####"/>	拾笔延迟:	<input type="text" value="###"/>	y轴偏移:	<input type="text" value="###.##"/>
刀速:	<input type="text" value="#####"/>	下刀延迟:	<input type="text" value="###"/>		
刀加速:	<input type="text" value="#####"/>	拾刀延迟:	<input type="text" value="###"/>		
空速:	<input type="text" value="#####"/>	x校正:	<input type="text" value="###"/>		
空加速:	<input type="text" value="#####"/>	y校正:	<input type="text" value="###"/>		

⋮

X            X  
               Y  
 X        (    ):        X  
           (    ):        Y

2



### 功能设置

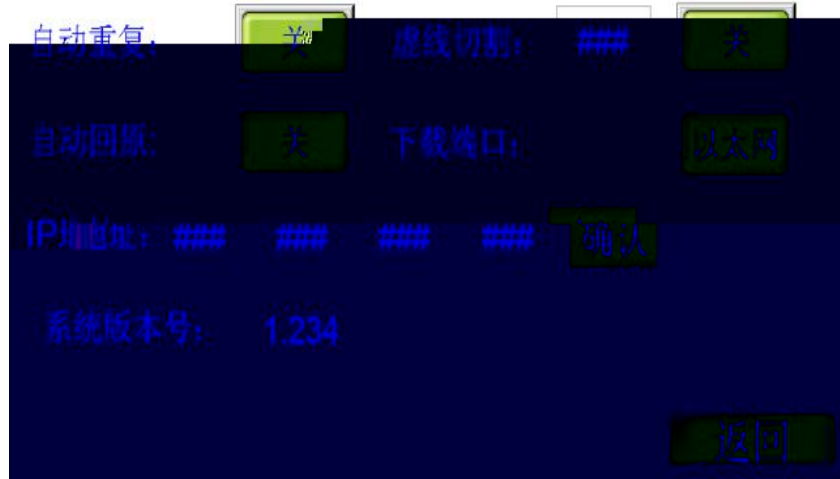

IP

IP

3

IP

IP

IP

3



10

11            3

